

## FIRST CLASS • DATED MATERIAL

Karen Sanders, FTS

Mail entries to: 13120 SE Wiese Rd Damascus, OR. 97089

503-658-4363(house)

503-819-5217(cell)

allagantesilkens@yahoo.com

### Directions to the Site:

**From the North or South:** From I-5 take the I-205 Exit.

Travel to the Hwy 224 – Estacada/Damascus Exit and head east.

Go east approximately 7 miles to Damascus.

From the main intersection of the town of Damascus (Safeway on left hand side of road and McDonalds on right hand side of road) continue to the second road on the left which is WIESE RD.

Turn left onto Wiese and travel approximately 3/4 miles to ALLAGANTE SILKENS 13120 SE Wiese Rd.) on the right side of the road.

You will travel down a gravel drive and through a gate which you will have to OPEN AND CLOSE, then up the drive the rest of the way.

### **Cell phones on the Field –**

Karen Sanders – 503-819-5217,

Tammy Mills – 503-302-8447

Paul Sanders – 503-320-9643

## NWFest PREMIUM LIST

EARLY ENTRIES CLOSE 7:00 PM, Thursday, July 16, 2015

Send to 13120 SE Wiese Rd; Damascus OR 97089

DAY OF TRIAL ENTRIES CLOSE **Sunday, July 19, 2015, 9:00 AM** at the FTS's table

## SORCA

**Southern Oregon Racing & Coursing Association**

### **ASFA ALL-BREED TRIAL**

#### **REGION 1**

**Sunday, July 19, 2015**

**Site:** 13120 SE Wiese Rd; Damascus OR 97089

**LIMITED CERTIFICATIONS WILL BE OFFERED AT 8:00 AM Sunday morning –contact FTS as soon as possible to reserve your dog's spot – must have your own by dog.**

#### **Roll Call – 9:00 AM**

#### **Early Entry Fees**

FIRST HOUND .....	\$20.00
SECOND HOUND.....	\$18.00
ALL ADDITIONAL HOUNDS .....	\$16.00

#### **Day-of-Trial Entry Fees**

ALL HOUNDS.....	\$25.00
-----------------	---------

Checks to be made to SWEPT for this event since this is a multiple event weekend

All Hounds entering for the first time MUST include a completed ASFA Certification Form or Waiver Form (with proof of title) and a copy of the hound's registration certificate (registration requirement waived for NGA Greyhounds only; Certification waived for Single Stake entries only).
--

*Permission has been granted by the American Sight hound Field Association for the holding of this event under ASFA Rules and Regulations.  
Audrey Silverstein, ASFA Scheduling Committee.*

---

## SORCA

### Southern Oregon Racing and Coursing Assoc.

President.....Ann Billups  
 Vice President.....Bill Martin  
 Secretary/Treasurer.....Ann Chamberlain

#### JUDGES

Ann Chamberlain.....Myrtle Creek, OR.  
 Charles Roberts.....>.....Oregon City, OR

Sunday	AH	AZ	BA	BZ	CE	G	IB	IW	IG	P	RR	S	SD	SW	SL	W	LT D	Sn g
Chamberlain	x	x	x	x	x	x	x	x	x	x	x	x	x	x	x	x	x	x
Roberts	x	x	x	x	x	x	x	x	x	x	x	x	x	x	x	x	x	x

#### FIELD COMMITTEE

Chairman.....Paul Sanders  
 Secretary.....Karen Sanders  
 Clerk.....Tammy Mills  
 Huntmasters.....Jeff Morris, Jason Holmberg  
 Paddock Masters.....Linda Garland  
 Lure Operators.....Aaron Sweptson  
 Inspection.....Melissa Holmberg, Tammy Mills, Sarah Smith

Ribbons & Prizes may be offered by the host club.  
 TRIAL HOURS: 8:00 AM UNTIL AFTER PRIZES ARE AWARDED

**ROLL CALL: 9:00 AM - Day of trial entries & substitutions taken until 9:00 AM**

ENTRIES WILL NOT BE ACKNOWLEDGED BY RETURN MAIL OR PHONE;  
 ENTRIES MAY BE ACKNOWLEDGED BY E-MAIL IF OWNER REQUESTS SUCH &  
 GIVES E-MAIL ADDRESS.

#### Eligible Breeds and Registries

Only purebred Afghan Hounds, Azawakhs, Basenjis, Borzoi, Cirneco dell'Etna, Greyhounds, Ibizan Hounds, Irish Wolfhounds, Italian Greyhounds, Pharaoh Hounds, Rhodesian Ridgebacks, Salukis, Scottish Deerhounds, Silken Windhounds, Sloughis, and Whippets, may be entered in the regular stakes. Limited breeds may be entered in the Limited Stake or the Singles Stake. Limited breeds currently include purebred Chart Polski, Galgo Español, Magyar Agar, Peruvian Inca Orchid, Portuguese Podengo (Pequeno), Portuguese Podengo (Medio & Grande), and must be individually registered with the appropriate registry.

All entries in the regular stakes shall be individually registered with AKC (ILP/PAL included), UKC, NGA, FCI, an ASFA-recognized foreign or ASFA Board approved registry, or possess a Critique Registration Number (CRN) from the SPDBS. Dogs with an indefinite Listing Privilege (LP) or a purebred Alternate Listing (PAL) from the AKC shall be considered registered with that body. Limited and/or Provisional stake entries shall be individually registered with the appropriate registry. A photocopy of acceptable registry must be submitted with a hound's first ASFA field trial entry; this requirement is waived for Greyhounds registered with the NGA registry.

#### Regular Stakes Offered

All hounds entering Open, Veteran, or Limited stakes for the first time must include a completed certification form or waiver (all breeds) and a copy of the hound's registration certification with their entry ( waived for NGA Greyhounds only).

**OPEN STAKE:** Any eligible sighthound, excluding ASFA Field Champions of record.

**FIELD CHAMPION STAKE:** Any ASFA Field Champion.

**VETERAN STAKE:** Any eligible hound whose age is at least six years, except Irish Wolfhounds whose age shall be at least five years, and Afghan Hounds, Rhodesian Ridgebacks, Salukis, and Whippets whose age shall be at least seven years. Points go toward V-FCh or V-LCM titles.

**LIMITED STAKE:** Any eligible sighthound of a Limited stake breed that has met certification requirements. Not eligible to compete in Best of Breed or Best in Field.

**SINGLES STAKE:** Any eligible sighthound including those disqualified to run in other stakes. Not eligible for Best of Breed or Best in Field. Hounds are eligible to earn TCP and CPX titles from the Singles stake. Limited breeds are not eligible for these titles.

#### BEST IN FIELD WILL BE OFFERED

**Conditions of Entry:** All entries must be one year or older on the day of the trial • Stakes will be split into flights by public random draw if the entry in any regular stake is 20 or more • Bitches in season, lame hounds and hounds with breed disqualifications will be excused at roll call. Spayed, neutered, monorchid or cryptorchid hounds without breed disqualifications may be entered; hounds with breed disqualifications are not eligible to enter except in the Single Stake • Hounds not present at the time of roll call will be scratched • All hounds will run twice, in

trios if possible or braces (except in the Single Stake), unless excused, dismissed or disqualified.

**Equipment:** Type of lure machine: battery-powered take-up reel [drag lure];  
Type of lures: highly-visible plastic strips.

### COURSE PLAN

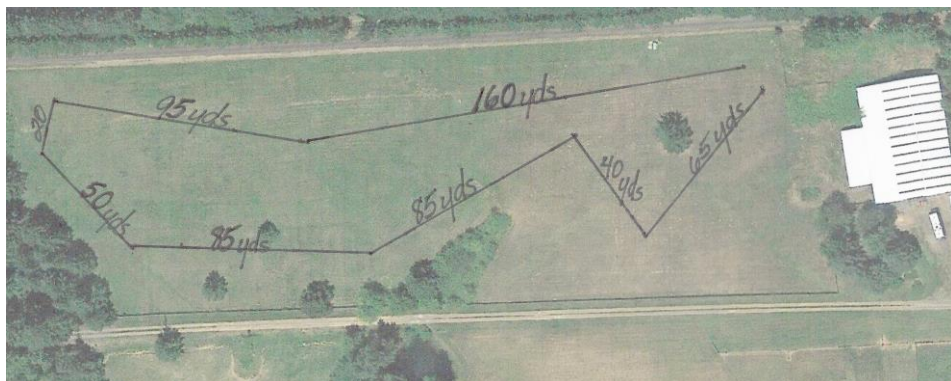

The course plan is **600** yards. The course will be reversed for finals and again for run-offs, or at the discretion of the judges. SORCA reserves the right to alter the course due to field or weather conditions on the day of the trial. **EACH HOUND IS ENTERED AND COMPETES AT THE SOLE RISK OF ITS OWNER.**

### Veterinarian on Call:

Northwest Veterinary Specialists (24/7 emergency service)  
16756 SE 82<sup>nd</sup> Drive; Clackamas, OR 97015  
503-656-3999

\*\*\*\*\*

**PLEASE BRING YOUR OWN WATER & SHADE ~~ OVERNIGHT PARKING IS PERMITTED,  
NO HOOK-UPS  
CERTIFICATIONS WILL BE OFFERED**

\*\*\*\*\*

### FOOD AND CATERING

Fast Food and supermarkets are less than 1 mile from site, however there will be late lunch/early dinner (taco buffet for \$8.50) available for sale but must be indicated wanting to buy, no later than 7/16/2015.

### Accommodations:

Both RV and tent camping are available onsite.  
Please provide your space requirements no later than the close of entries.

If you prefer camping at a park, Barton Park (which is quite nice) is located about 10 to 15 minutes away.

Barton Park (reservations are needed-first come first serve) 503-742-4414  
[www.clackamas.us/parks/barton.htm](http://www.clackamas.us/parks/barton.htm)

**HOTELS:** There are many hotels in the vicinity. The following is a list of pet friendly places, all of which are within about 20 minutes or less of driving time to the event site. Since pet rooms may be limited, we strongly suggest you make reservations well in advance.

Motel 6  
1610 NW Frontage Road, Troutdale, OR  
503-665-2254 [www.motel6.com](http://www.motel6.com)

Comfort Suites  
15929 SE McKinley Ave, Clackamas, OR 97015  
503-723-6450 [www.comfortsuites.com](http://www.comfortsuites.com)

Super 8  
121 NE 181st Avenue, Portland, OR 97230  
503-661-5100 [www.super8.com](http://www.super8.com)

Days Inn  
24124 SE Stark St.; Gresham, OR 97030  
503-465-1515 [www.daysinn.com](http://www.daysinn.com)

Clackamas Inn & Suites  
16010 E 82nd Dr., Clackamas, OR  
503-650-5340 [www.clackamasinn.com](http://www.clackamasinn.com)

Oxford Suites  
75 82nd Dr., Gladstone, OR 97027  
503-722-7777 [www.oxfordsuites.com](http://www.oxfordsuites.com)

Fagan's Haven Bed & Breakfast  
1402 SE Holly View Terrace, Damascus, OR 97089  
503-658-2010 [www.faganshavenbnb.co](http://www.faganshavenbnb.co)

OFFICIAL AMERICAN SIGHTHOUND FIELD ASSOCIATION ENTRY FORM  
SORCA

Southern Oregon Racing & Coursing Assoc.

Early Entries close Thursday, July 16, 2015, 7:00 PM

Early Entries fees: 1<sup>st</sup> hound \$20.00, 2<sup>nd</sup> Hound \$18.00 & each additional hound \$16.00

Day-of-Trial Entries: Sunday July 19, close 9:00 AM----Day-of Entry fees: All Hounds \$25.00

Make checks payable to **SWEPT**. Mail to:

Karen Sanders, Field Trial Secretary, 13120 SE Wiese Rd., Damascus OR 97089

Fee Paid \_\_\_\_\_ The Field Secretary cannot accept conditional, unsigned, incomplete or unpaid entries; please check your completed entry carefully.

Breed:	Call Name:		
Registered Name of Hound:			
Stake: <input type="checkbox"/> Open <input type="checkbox"/> FCH <input type="checkbox"/> Veteran <input type="checkbox"/> Single <input type="checkbox"/> Limited		Additional Stakes: <input type="checkbox"/> Kennel <input type="checkbox"/> Breeder <input type="checkbox"/> Bench	
Registration Number: (please write in registering body before number)			
<input type="checkbox"/> If possible, please separate my hounds	Date of Birth:	Sex: <input type="checkbox"/> Dog <input type="checkbox"/> Bitch	
Name of actual owner(s):			
Address:		Phone:	
City:	State:	Zip:	
E-mail (Optional)		(Optional) Region of Residence:	
<input type="checkbox"/> Check if this is the first ASFA trial for this hound. Attach a Hound Certification or waiver if entered in Open, Veterans, Limited.			
<input type="checkbox"/> Check if this is a first-time entry, a copy of the official Registration of this hound must accompany this entry unless NGA.			
<input type="checkbox"/> Check if any information has changed since the last ASFA trial entry. Regarding _____			
<input type="checkbox"/> Check if this hound has been dismissed within the last 6 trials entered. Must be marked in order to qualify for a "clean" trial requirement.			

I CERTIFY that I am the actual owner of this dog, or that I am the duly authorized agent of the actual owner whose name I have entered above. In consideration of the acceptance of this entry and the opportunity to have this dog judged and to win prize money, ribbons, or trophies, I (we) agree to abide by the rules and regulations of the American Sighthound Field Association in effect at the time of this lure field trial, and by any additional rules and regulations appearing in the premium list for this lure field trial. I (we) agree that the club holding this lure field trial has the right to refuse this entry for cause, which the club shall deem to be sufficient. I (we) agree to hold this club, its members, directors, governors, officers, agents or other functionaries, any employees of the aforementioned parties and the owner(s) of the trial premises or grounds harmless from any claim for loss or injury which may be alleged to have been caused directly or indirectly to any person or thing by the act of this dog while in or upon the lure field trial premises or grounds or near any entrance thereto and I (we) personally assume all responsibility and liability for any such claim, and I (we) further agree to hold the aforementioned parties harmless from any claim loss of this dog by disappearance, theft damage or injury be caused or alleged to be caused by the negligence of the club or any of the aforementioned parties or by the negligence of any person or any other cause or causes. I (we) certify and represent that the dog entered is not a hazard to person or other dogs. This entry is submitted for acceptance of the forgoing representations and agreements

**SIGNATURE** of owner or his agent  
duly authorized to make this entry \_\_\_\_\_

OFFICIAL AMERICAN SIGHTHOUND FIELD ASSOCIATION ENTRY FORM  
SORCA

Southern Oregon Racing & Coursing Assoc.

Early Entries close Thursday, July 16, 2015, 7:00 PM

Early Entries fees: 1<sup>st</sup> hound \$20.00, 2<sup>nd</sup> Hound \$18.00 & each additional hound \$16.00

Day-of-Trial Entries: Sunday July 19, close 9:00 AM----Day-of Entry fees: All Hounds \$25.00

Make checks payable to **SWEPT**. Mail to:

Karen Sanders, Field Trial Secretary, 13120 SE Wiese Rd., Damascus OR 97089

Fee Paid \_\_\_\_\_ The Field Secretary cannot accept conditional, unsigned, incomplete or unpaid entries; please check your completed entry carefully.

Breed:	Call Name:		
Registered Name of Hound:			
Stake: <input type="checkbox"/> Open <input type="checkbox"/> FCH <input type="checkbox"/> Veteran <input type="checkbox"/> Single <input type="checkbox"/> Limited		Additional Stakes: <input type="checkbox"/> Kennel <input type="checkbox"/> Breeder <input type="checkbox"/> Bench	
Registration Number: (please write in registering body before number)			
<input type="checkbox"/> If possible, please separate my hounds	Date of Birth:	Sex: <input type="checkbox"/> Dog <input type="checkbox"/> Bitch	
Name of actual owner(s):			
Address:		Phone:	
City:	State:	Zip:	
E-mail (Optional)		(Optional) Region of Residence:	
<input type="checkbox"/> Check if this is the first ASFA trial for this hound. Attach a Hound Certification or waiver if entered in Open, Veterans, Limited.			
<input type="checkbox"/> Check if this is a first-time entry, a copy of the official Registration of this hound must accompany this entry unless NGA.			
<input type="checkbox"/> Check if any information has changed since the last ASFA trial entry. Regarding _____			
<input type="checkbox"/> Check if this hound has been dismissed within the last 6 trials entered. Must be marked in order to qualify for a "clean" trial requirement.			

I CERTIFY that I am the actual owner of this dog, or that I am the duly authorized agent of the actual owner whose name I have entered above. In consideration of the acceptance of this entry and the opportunity to have this dog judged and to win prize money, ribbons, or trophies, I (we) agree to abide by the rules and regulations of the American Sighthound Field Association in effect at the time of this lure field trial, and by any additional rules and regulations appearing in the premium list for this lure field trial. I (we) agree that the club holding this lure field trial has the right to refuse this entry for cause, which the club shall deem to be sufficient. I (we) agree to hold this club, its members, directors, governors, officers, agents or other functionaries, any employees of the aforementioned parties and the owner(s) of the trial premises or grounds harmless from any claim for loss or injury which may be alleged to have been caused directly or indirectly to any person or thing by the act of this dog while in or upon the lure field trial premises or grounds or near any entrance thereto and I (we) personally assume all responsibility and liability for any such claim, and I (we) further agree to hold the aforementioned parties harmless from any claim loss of this dog by disappearance, theft damage or injury be caused or alleged to be caused by the negligence of the club or any of the aforementioned parties or by the negligence of any person or any other cause or causes. I (we) certify and represent that the dog entered is not a hazard to person or other dogs. This entry is submitted for acceptance of the forgoing representations and agreements

**SIGNATURE** of owner or his agent  
duly authorized to make this entry \_\_\_\_\_

**AMERICAN SIGHTHOUND FIELD ASSOCIATION  
HOUND CERTIFICATION**

**Rule effective October 1, 1994: Ch. V, Sec. 4 (a) OPEN STAKE:** *To be eligible to enter the open stake, a hound must have been certified by a licensed judge within the year preceding the closing date for the entry or have previously competed in the Open Stake.* This eligibility requirement also applies to a hound entered in the Limited or Veteran Stake, which has not competed in Open previously. Please complete this portion of this form and attach it to the entry form for the hound's first entry, including an entry for a Fun Trial.

Registered Name of Hound: \_\_\_\_\_

Registration Number: \_\_\_\_\_ Breed: \_\_\_\_\_

Registered Owner's Name: \_\_\_\_\_

I hereby certify that on (date) \_\_\_\_\_, the above named hound completed a lure course of at least 500 yards, running with another hound of the same breed (or another breed with a similar running style). During the course the above named hound showed no inclination to interfere with the other hound. I further certify that I am a licensed judge for the ASFA.

Name of Licensed Judge: \_\_\_\_\_

Signature: \_\_\_\_\_ Date: \_\_\_\_\_

I hereby certify that the hound running in the certification course is the hound identified above and that information provided on this form is true and correct.

Signature: \_\_\_\_\_ Date: \_\_\_\_\_

Owner or Authorized Agent of Hound

This certification form must be attached to the entry form the first time this hound is entered in an open, limited, or veteran stake. Any hound entered in open, limited, or veteran (as a first time entered hound), which has not been certified, shall be declared ineligible by the records coordinator and shall forfeit any points and placements awarded.

**PLEASE RETAIN A COPY FOR YOUR RECORDS.**

**AMERICAN SIGHTHOUND FIELD ASSOCIATION  
HOUND CERTIFICATION WAIVER**

**Waiver of Requirement:** *This requirement will be waived for a hound that has earned a lure coursing or racing title from another recognized organization, if such title requires competition, and if a waiver for such title has been approved by the ASFA, or a CKC Hound Certification Form.* If your hound qualifies for a waiver, complete this portion of this form and attach it to your entry form. Proof of waivers must accompany this certification form.

Registered Name of Hound: \_\_\_\_\_

Registration Number: \_\_\_\_\_ Breed: \_\_\_\_\_

Registered Owner's Name: \_\_\_\_\_

**CKC:** FCH FCHX **CWA:** ARX TRP SRA DPC

**AKC:** QC SC FC **LGRA:** GRC **NAWRA:** RCH SR

**WRA:** CR WRCH **NOTRA:** ORC OTR SORC SOR

Hound Certification previously submitted.

I hereby certify that the hound identified above has completed the requirements for the title indicated above (or that the required Certification was previously submitted) and that the information provided on this form is true and correct.

Signature: \_\_\_\_\_ Date: \_\_\_\_\_

Owner or Authorized Agent of Hound

**AMERICAN SIGHTHOUND FIELD ASSOCIATION  
HOUND CERTIFICATION**

**Rule effective October 1, 1994: Ch. V, Sec. 4 (a) OPEN STAKE:** *To be eligible to enter the open stake, a hound must have been certified by a licensed judge within the year preceding the closing date for the entry or have previously competed in the Open Stake.* This eligibility requirement also applies to a hound entered in the Limited or Veteran Stake, which has not competed in Open previously. Please complete this portion of this form and attach it to the entry form for the hound's first entry, including an entry for a Fun Trial.

Registered Name of Hound: \_\_\_\_\_

Registration Number: \_\_\_\_\_ Breed: \_\_\_\_\_

Registered Owner's Name: \_\_\_\_\_

I hereby certify that on (date) \_\_\_\_\_, the above named hound completed a lure course of at least 500 yards, running with another hound of the same breed (or another breed with a similar running style). During the course the above named hound showed no inclination to interfere with the other hound. I further certify that I am a licensed judge for the ASFA.

Name of Licensed Judge: \_\_\_\_\_

Signature: \_\_\_\_\_ Date: \_\_\_\_\_

I hereby certify that the hound running in the certification course is the hound identified above and that information provided on this form is true and correct.

Signature: \_\_\_\_\_ Date: \_\_\_\_\_

Owner or Authorized Agent of Hound

This certification form must be attached to the entry form the first time this hound is entered in an open, limited, or veteran stake. Any hound entered in open, limited, or veteran (as a first time entered hound), which has not been certified, shall be declared ineligible by the records coordinator and shall forfeit any points and placements awarded.

**PLEASE RETAIN A COPY FOR YOUR RECORDS.**

**AMERICAN SIGHTHOUND FIELD ASSOCIATION  
HOUND CERTIFICATION WAIVER**

**Waiver of Requirement:** *This requirement will be waived for a hound that has earned a lure coursing or racing title from another recognized organization, if such title requires competition, and if a waiver for such title has been approved by the ASFA, or a CKC Hound Certification Form.* If your hound qualifies for a waiver, complete this portion of this form and attach it to your entry form. Proof of waivers must accompany this certification form.

Registered Name of Hound: \_\_\_\_\_

Registration Number: \_\_\_\_\_ Breed: \_\_\_\_\_

Registered Owner's Name: \_\_\_\_\_

**CKC:** FCH FCHX **CWA:** ARX TRP SRA DPC

**AKC:** QC SC FC **LGRA:** GRC **NAWRA:** RCH SR

**WRA:** CR WRCH **NOTRA:** ORC OTR SORC SOR

Hound Certification previously submitted.

I hereby certify that the hound identified above has completed the requirements for the title indicated above (or that the required Certification was previously submitted) and that the information provided on this form is true and correct.

Signature: \_\_\_\_\_ Date: \_\_\_\_\_

Owner or Authorized Agent of Hound